

INVO-II Series

Hybrid Energy Storage Invert



Product Snapshot

Model: 3-5.5kW

Nominal Voltage: 220/230/240VAC

Frequency Range: 50Hz/60Hz



Touch Display Screen



Dust Proof

Hybrid Operation

With battery connected

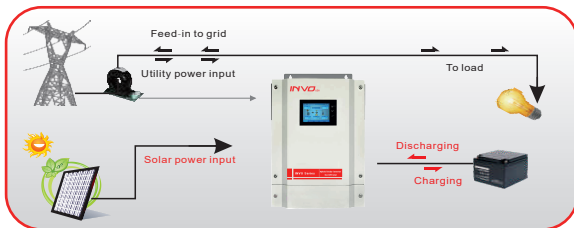

Without battery connected

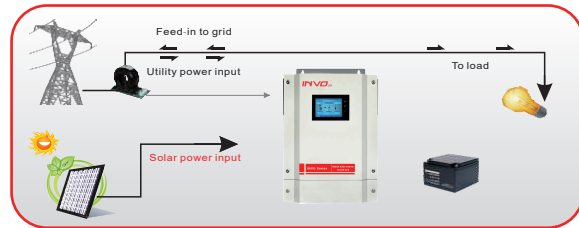

Key Features:

- Touch screen display.
- PV and utility power the load at same time (can setting).
- Output power factor $PF=1.0$.
- On&Off Grid with energy storage.
- Energy generated record, load record, history information and fault record.
- Structure with dust filter.
- AC charging start and stop time setting.
- External Wi-Fi device optional.
- Parallel operation up to 9 units .
- Connected with battery optional.
- Wide PV input range 120-450VDC.
- Independent CPU.
- MAX PV Array power 5000W.
- Solar and Utility supply power to the load When solar power is not sufficient to load.
- The CT sensor will monitor the power consumption of the system and will make sure no excess PV power is delivered to the Grid.

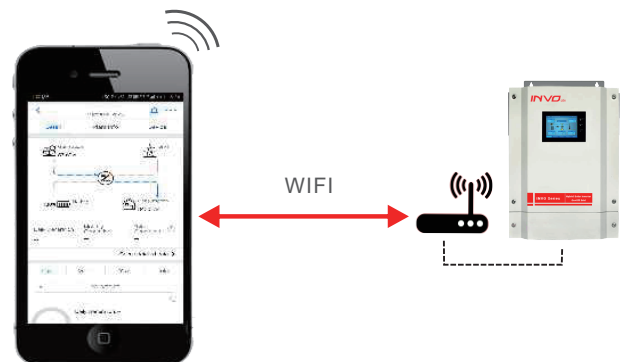

■ Single phase output up to 49.5KW using 9 units

■ Three phase output using either 3 units(16.5KW)or max 9 units(49.5KW)

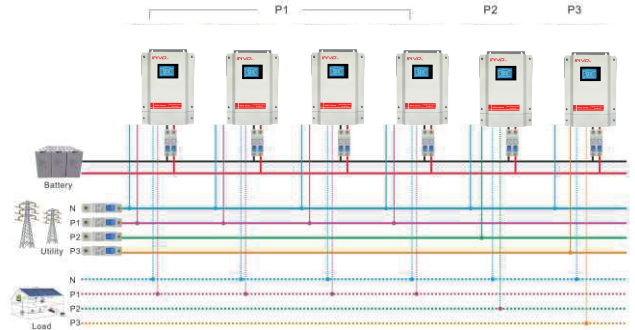
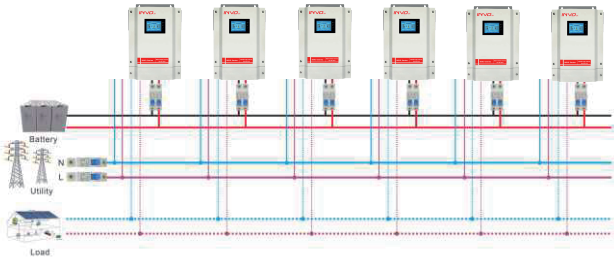

INVO-II Series

Wall Mounted Integrated Solar Power Inverter Technical Specification Built-in MPPT Solar Controller

MODEL	INVO II 5.5k-48
Max PV Array Power	5000W
Rated Output Power	5500W
Maximum PV Array Open Circuit Voltage	500VDC
MPPT Range @ Operating Voltage	120-450VDC
GRID-TIE OPERATION	
GRID OUTPUT (AC)	
Nominal Output Voltage	220/230/240VAC
Output Voltage Range	184-265VAC
Nominal Output Current	25A/23.9A/22.9A
Efficiency	Up to 93.5%
OFF-GRID, HYBRID OPERATION	
GRID INPUT	
Acceptable Input Voltage Range	120-280VAC or 170-280 VAC
Frequency Range	50Hz/60Hz (Auto sensing)
BATTERY MODE OUTPUT (AC)	
Nominal Output Voltage	220/230/240VAC
Output Wave form	Pure sine wave
BATTERY & CHARGER	
Nominal DC Voltage	48VDC
Maximum Solar Charge Current	90A
Maximum AC Charge Current	60A
Maximum Charge Current	90A
Emergency output power	
Maximum output Power	5500W
Surge Power	11000W
Automatic Transfer Time	<8ms
GENERAL	
INTERFACE	
Parallel Function	Yes
Communication	USB or RS232/Dry-Contact
ENVIRONMENT	
Humidity	0~90% RH (No Condensing)
Operating Temperature	0 to 50 °C
Net Weight(KG)	11.9
Gross Weight(KG)	13.1
Dimension (W x D x H)mm	345x476x133.2