

# BioPro ST40 & ST40-A

## Fingerprint Recognition TA & Access Terminal



BioPro ST40 & ST40-A is a fingerprint identification time & attendance and access control terminal, which can connect with third party electric lock, door sensor and exit button etc.

Communicating via Wi-Fi, TCP/IP, 3G and USB host, it ensures a smooth connection and data transfer.

It's associated with ZK new fingerprint reader, the operation remains stable under strong light source and high preciseness of verification of wet and rough fingers. Amazing verification speed and intuitive Operation process make it popular. It will match your slap-up office perfectly.

### Features



Built in PoE



1 channel auxiliary input for smoke detector connection



Built in battery, up to 4 hours



Multiple communicate mode, Wi-Fi, TCP/IP, 3G, USB host



Stable operation under strong light source



Advance access function including Lock connection, alarm, Wiegand input/output

# Specifications

<b>Product</b>		BioPro ST40	BioPro ST40-A
<b>Main</b>	Biometric	Fingerprint	
	RF Optional	125kHz EM / 13.56MHz MF	
<b>Capacity</b>	Max User(1:N)	10,000	
	Max Fingerprint (1:N)	3,000 standard / 10,000 Optional	
	Max Record	100,000	
<b>Interface</b>	TCP/IP	10/100 M	
	PoE Optional	802.3 at 28W	
	Wi-Fi	802.11 B/G/N	
	3G Optional	WCDMA	
	USB	USB 2.0 (Host)	
	RS232	1 port for external printer	
	RS485		1 port for FP reader
	Relay		2 relays
Wiegand	-	1ch In & Out	
Input		1 Input	
<b>Hardware</b>	LCD	2.8" Color LCD	
	Sound	24-bit	
	Operating Temp.	0 °C - 45 °C	
	Operating Humidity	20% ~ 80%	
	Power	DC 12V 1.5A	DC 12V 3A
	Dimensions(W x H x D mm)	213*155*107.81mm	
	Certificates	CE, FCC, RoHS	
<b>Function</b>	Standard	Automatic Status Switch, Self-Service Query, DST, T9 Input, 9 Digit User ID, Scheduled Bell, Photo ID, Lock, Sensor, Exit button, ADMS	
	Optional	ID / Mifare	
<b>Compatibility</b>	Software	BioTime 7.0	

## Configuration

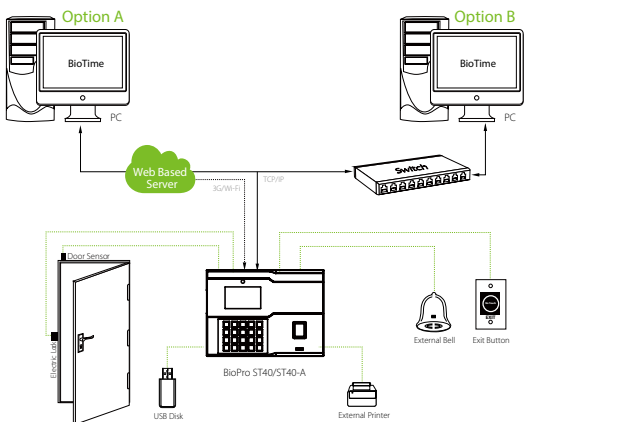

## Dimensions (mm)

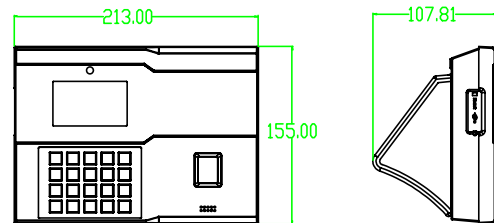

ZKTeco Middle East  
 E-mail: [zk\\_me@zkteco.com](mailto:zk_me@zkteco.com)  
[www.zkteco.me](http://www.zkteco.me)

© Copyright 2017. ZKTECO CO.,LTD. ZKTeco Logo is a registered trademark of ZKTeco or a related company. All other product and company names mentioned are used for identification purposes only and may be the trademarks of their respective owners. All specifications are subject to change without notice. All rights reserved.

